

## HASP LOCK

Designed for lockers up to 20 mm thick, and heavy duty use in collective installations.

Suitable for wet area use thanks to the materials used.

Equipped with anti-rotation system

Optionally with backplate if the customer wants to use another system in the future (Coin lock, OTS proximity lock, etc.).

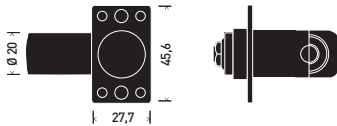

### HASP LOCK

#### TECHNICAL SPECIFICATIONS

AVAILABILITY	Right / left.
FIXING	Screwed.
ROTATION	180°
CLOSING	With padlock of up to 8 mm in diameter.
FINISHES	Chrome.
MATERIALS	Lock in zamak and Cam in steel.

#### MECHANICAL REQUIREMENTS

No. of cycles: 60,000 cycles according to the LGA guidelines  
48 hours in salt spray test.  
Resistance: 50 kg/f.

#### ACCESSORY OPTION

Backplate for OTS and coin lock footprint. 039.002PN

#### TECHNICAL DRAWING

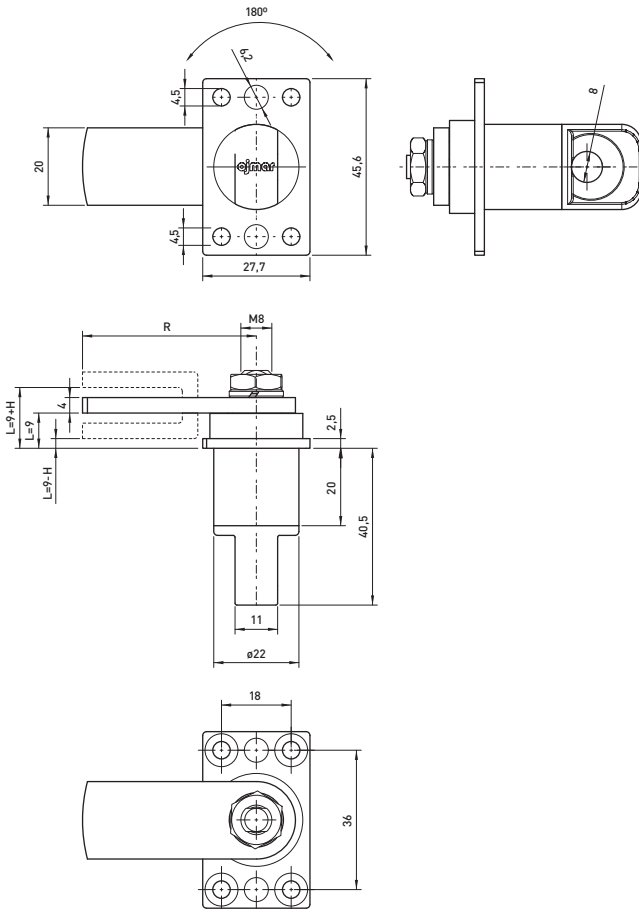

Prefect Equipment Ltd  
153b High Street  
Teddington  
TW11 8HH  
[www.prefectlockers.com](http://www.prefectlockers.com)